

AVENUE_{Patented}

metalfire

Technical Document

AVENUE MF 1050-40 GHE 1S

Dimensions (mm)

- combustion opening WxH: 1050x390
- external WxDxH: 1178x444x770
- diameter flue: Ø130/200 or
(*) Ø100/150

TECHNICAL DATA

- Gascat: I2E+, I2E, I2H, I2L, I2ELL
- ECOLABEL: B
- load input: 9,40 kW
- load output: 8,00 kW
- efficiency capacity: 84,8 %
- type of gas/pressure: G20/G25

- Gascat: I3B/P, I3+
- ECOLABEL: B
- load input: 8,00 kW
- load output: 7,00 kW
- efficiency capacity: 88,8 %
- type of gas/pressure: G30/G31

- Appliance type: C11,C31,C91
C12,C32,C42,C52,C82
- Weight: 100 kg
- Convection air inlet: min700cm² (4xØ150)
- Convection air outlet: min700cm² (4xØ150)

SPECIFICATIONS

- Available with pebbles, optional ceramics wood logs
- Ionization-protected pilot-flame
- Radiographic remote controle with thermostatic mode
- Inside finishing: heat-resistant black paint
- Gas/electrical connections at the left side
(optional right side)

OPTIONS

- interior finishing: ORIGINAL (ribbed cast iron)
 Standard (steel)

First aid and technical support:

- support@metalfire.eu
- +32 (0)9 261 50 57

scale 1:20

www.metalfire.eu

EN 613

CE

General dimensional tolerances up to 6mm
Metalfire preserves the right to modify specifications without previous notice

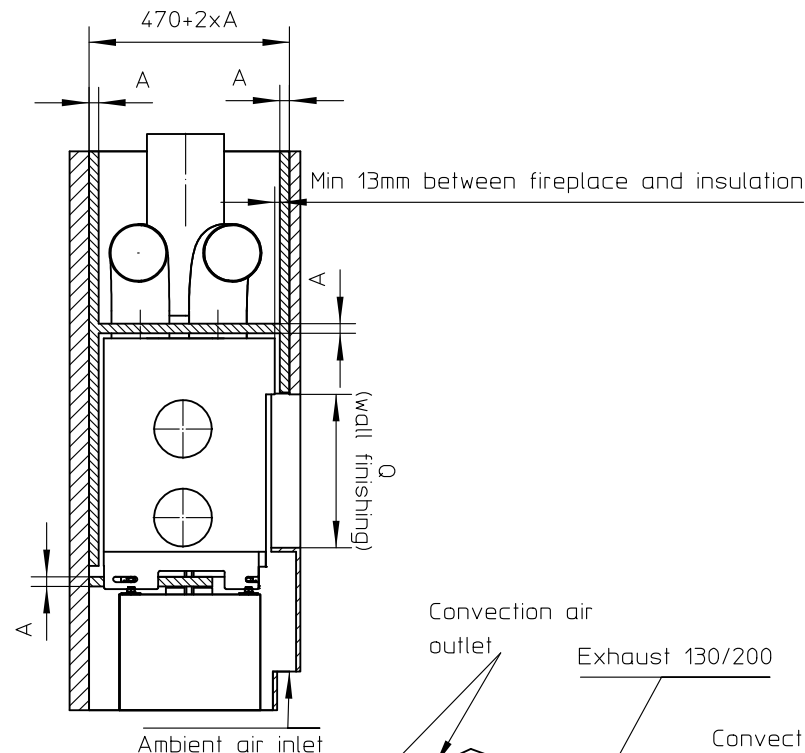
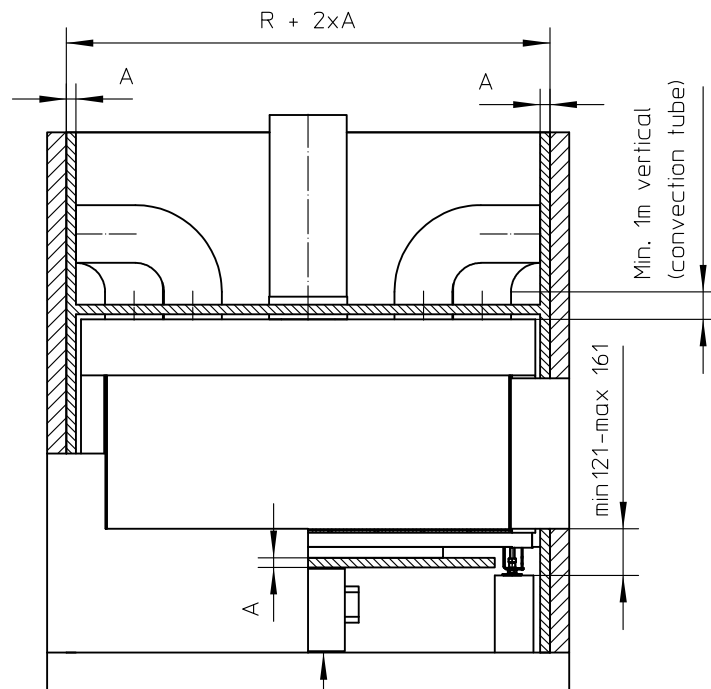

Sheet
1/3

WITHOUT FINISHING FRAME

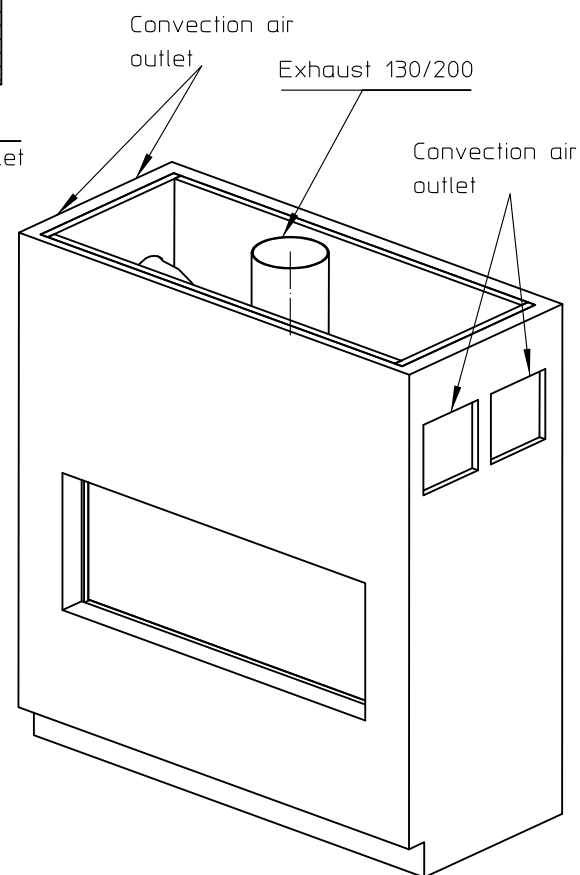
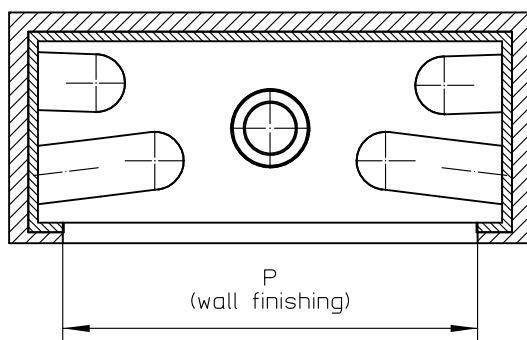

Electrical/gas controle unit
Standard connected with 1m flexible tube.
Optional: connected on right side and/or with an additional 1m tube(AT ORDER)
FORESEE ENOUGH AIR FLOW FOR COOLING



 Combustable finishing material
 Insulation
Insulation thickness = > see table

AVENUE Patented

metalfire

Technical Document

AVENUE MF 1050-40 GHE 1S

Prescribed insulation thickness (mm)

Combustable finishing material

Metalfire recommended
Promasil 1100L
(TC=0,081 W/mK)

A = 25mm

Non-combustable finishing material

non-combustable
materials
structural building items
EXCLUDED e.g load bearing walls

A = 0mm

TC=thermot conductivity

TC=non-combustable

Table: AVENUE MF 1050-40 GHE 1S

Installation dimensions (mm)

P	Q	R	S	T	Z
1050	390	1204	1076	416	NA

First aid and technical support:
- support@metalfire.eu
- +32 (0)9 261 50 57

scale 1:20

Rev.

www.metalfire.eu

EN 613

CE

General dimensional tolerances up to 6mm
Metalfire preserves the right to modify specifications without previous notice

Sheet
2/3

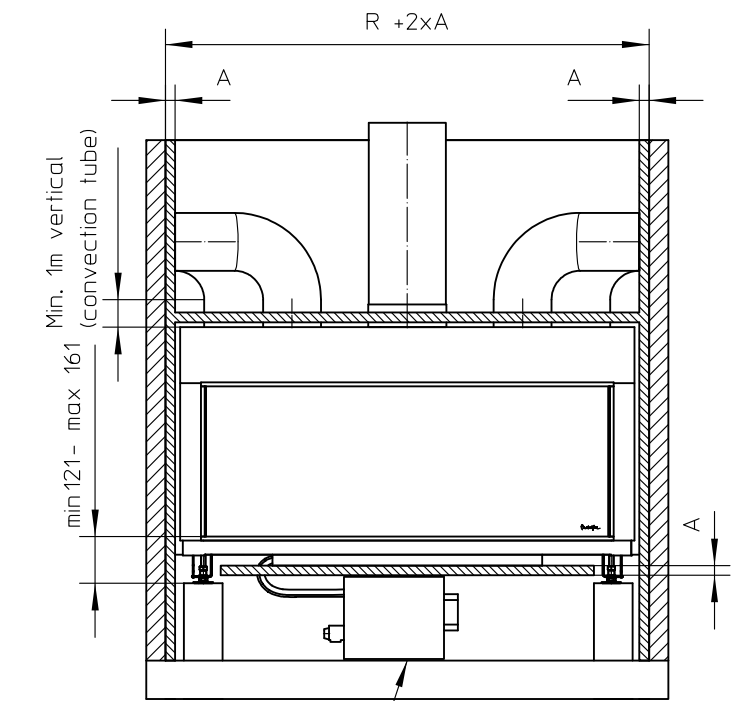

Electrical/gas controle unit
 Standard connected with 1m flexible tube.
 Optional: connected on right side and/or with an additional 1m tube(AT ORDER)
 FORESEE ENOUGH AIR FLOW FOR COOLING

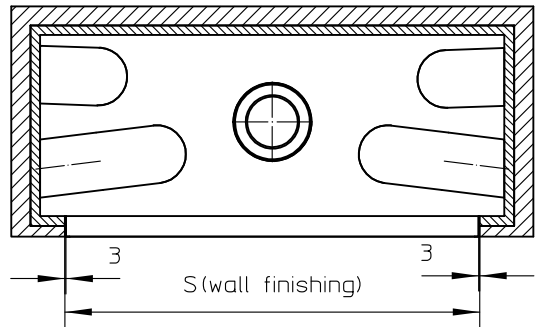

Combustable finishing material
 Insulation
 Insulation thickness = > see table

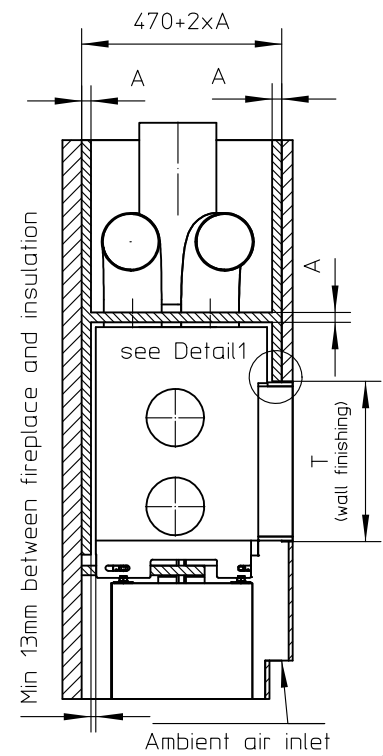

WITH FINISHING FRAME 90/10

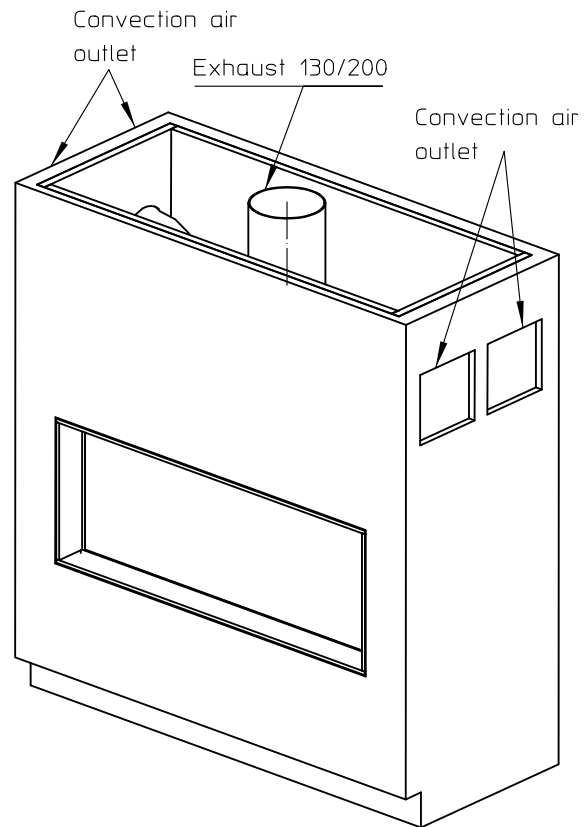
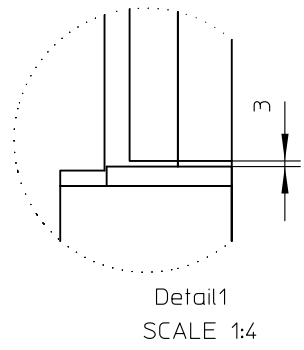

AVENUE Patented

metalfire

Technical Document

AVENUE MF 1050-40 GHE 1S

Prescribed insulation thickness (mm)

Combustable finishing material

Metalfire recommended Promasil 1100L (TC=0,081 W/mK)	A = 25mm
--	----------

Non-combustable finishing material

non-combustable materials structural building items EXCLUDED e.g load bearing walls	A = 0mm
--	---------

TC=thermot conductivity TC=non-combustable

Table: AVENUE MF 1050-40 GHE 1S

Installation dimensions (mm)

P	Q	R	S	T	Z
1050	390	1204	1076	416	NA

First aid and technical support:
 - support@metalfire.eu
 - +32 (0)9 261 50 57

scale 1:20 Rev.

www.metalfire.eu EN 613 CE

General dimensional tolerances up to 6mm
 Metalfire preserves the right to modify specifications without previous notice Sheet 3/3